

Kerbverbinder

Werkstoff: E-Cu



Oberfläche: galvanisch verzinkt

Butt connectors

standard type

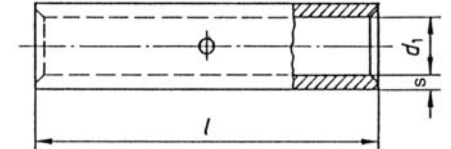
material: E-Cu, tin-plated



Nenn- querschnitt mm ²	Artikel-Nr.	Abmessung mm			1000 Stck. ~ kg	VE / Stück	
		d ₁	l	s			
6 AWG 10	02200	3,5	25	1,50	4,0	500	100
10 AWG 8	02205	5,0	30	1,00	5,0	500	100
16 AWG 6	02210	5,5	35	1,25	9,0	500	100
25 AWG 4	02215	6,9	40	1,50	12,0	500	50
35 AWG 2	02220	8,5	45	1,70	21,0	100	50
50 AWG 0	02225	10,0	50	2,10	28,0	100	50
70 AWG 2/0	02230	12,0	55	2,10	41,0	100	25
95 AWG 3/0	02235	13,5	60	2,25	54,0	50	25
120 AWG 4/0	02240	15,0	65	2,25	74,0	25	
150 AWG 5/0	02245	16,5	72	2,25	90,0	25	
185 AWG 6/0	02250	19,0	78	2,50	122,0	10	
240 AWG 500	02255	21,0	85	2,50	152,0	10	
300 AWG 600	02260	23,5	99	3,00	228,0	10	
400 AWG 800	02265	27,5	100	3,50	296,0	10	