

Load Break Disconnect Switches FSLBS

UL 508 Non-Fused Load Break Switches

The FSLBS Load Break Switch is a newly designed industrial-grade switch capable of making or breaking loads up to 600V. It is suitable as a motor disconnect. Extremely compact and robust, these switches have a variety of mounting options including DIN-rail, base, or door-mounting. A wide assortment of handles, shafts and accessories are available to accommodate any installation requirement. Both the toggle and rotary styles have a built-in pad-lockable hasp and the integrated box terminals are finger-safe to IP-20. Utilizing a patented, innovative design, the FSLBS can be actuated from the front or either side.

Highlights:

- **Terminals rated for 2 wires!**
- Front or side operation
- Padlockable
- Compact
- Robust
- DIN-rail, base, or door- mounting
- Choice of handles and shafts
- Side-mount auxiliary contacts and additional poles
- Double-break, silver-plated contacts

Applications:

- On/Off switching and disconnect applications in circuits up to 600V, 80A on the load side of branch circuit protection fusing.
- Motor controller, suitable as motor disconnect
- Motor isolator
- General purpose



Ratings:

Volts : 600VAC

Amps : 16, 25, 40, 63, and 80A

Suitable as motor disconnect up to 40hp

Approvals:

- UL 508 listed E196672
- CSA 22.2 #14
- IEC 60947-3



Load Break Disconnect Switches FSLBS

Catalog Numbers - FSLBS

		Ampere Rating		16A	25A	40A	63A	80A	
Select a Switch	Toggle			FSLBST16	FSLBST25	FSLBST40	FSLBST63	FSLBST80	
	Rotary			FSLBS16	FSLBS25	FSLBS40	FSLBS63	FSLBS80	
Select a Handle & Shaft	Direct Operation Handle		No Shaft Required	FSHD	FSHD	FSHD	FSHD	FSHD	
			Select a Handle	NEMA 1, 3R, 12	Black	FSH00BR**	FSH00BR**	FSH00BR**	FSH0BR**
		NEMA 1, 3R, 12, 4, 4X	Black	FSH00BR4**	FSH00BR4**	FSH00BR4**	FSH0BR4**	FSH0BR4**	
		NEMA 1, 3R, 12	Red	FSH00RR**	FSH00RR**	FSH00RR**	FSH0RR**	FSH0RR**	
	Thru-door		NEMA 1, 3R, 12, 4, 4X	Red	FSH00RR4**	FSH00RR4**	FSH00RR4**	FSH0RR4**	FSH0RR4**
			Select a Shaft	150mm/5.9"	FS150	FS150	FS150	FS150	FS150
			200mm/7.9"	FS200	FS200	FS200	FS200	FS200	
			320mm/12.6"	FS320	FS320	FS320	FS320	FS320	
	Select Accessories	Auxiliary Contacts		NO/NC	FSACNONC	FSACNONC	FSACNONC	FSACNONC	FSACNONC
				NO/NO	FSACNONO	FSACNONO	FSACNONO	FSACNONO	FSACNONO
4th Pole*				FS4P16	FS4P25	FS4P40	FS4P63	FS4P80	
Neutral Pole* (not switched)				FSNP40	FSNP40	FSNP40	FSNP80	FSNP80	
Ground Pole* (not switched)				FSGP40	FSGP40	FSGP40	FSGP80	FSGP80	
Terminal Shrouds				FSTS40	FSTS40	FSTS40	FSTS80	FSTS80	
Door Mounting Kit				FSDMK	FSDMK	FSDMK	FSDMK	FSDMK	

*Consult factory for availability

**Either FSH00xxx or FSH0xxx can be used.

Pre-Break Auxiliary Contacts

Mount directly to the side of the switch. The top contact is pre-break, the bottom contact makes with the switch. Up to four devices can be added, in any combination (maximum of two additional poles).

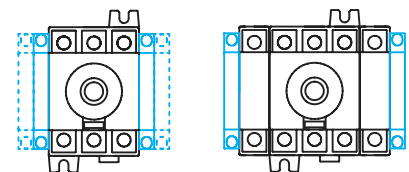

Door Mounting Kit

Allows mounting of the switch to a door or side panel. Utilizing the switch's side actuation provides access to the terminal screws, enabling the wiring to be completed after installation.



Padlocking Capabilities

Switch: With the switch in the 'Off' position, a hasp can be deployed that will lock the switch in this position.

Handle: The white lever in the center of the handle can be rotated out to reveal openings for up to 3 padlocks.

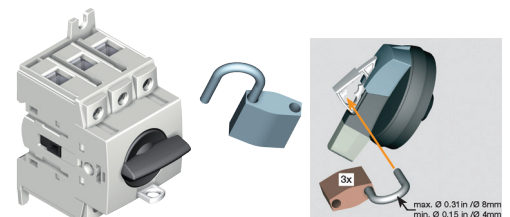

Load Break Disconnect Switches FSLBS

UL and CSA Characteristics - FSLBS

Technical Characteristics	16A	25A	40A	63A	80A
Short circuit current rating at 600 VAC	10kA/65kA	10kA/65kA	10kA/65kA	65kA/50kA	65kA/50kA
Fuse type	J/J	J/J	J/J	J	J
Maximum fuse rating (A)	60/30	60/30	60/30	60/100	60/100
Maximum Horsepower Rating / Max. motor FLA 3 φ					
208 VAC	3 / 11A	7.5 / 24A	7.5 / 24A	15 / 46A	15 / 46A
220 - 240 VAC	5 / 15A	7.5 / 22A	7.5 / 22A	20 / 54A	20 / 54A
440 - 480 VAC	10 / 14A	15 / 17A	20 / 27A	40 / 52A	40 / 52A
600 VAC	10 / 11A	20 / 22A	25 / 27A	40 / 41A	40 / 41A
Connection					
Solid (AWG)	#14 - #10	#14 - #10	#14 - #10	#14 - #10	#14 - #10
	2x #12	2x #12	2x #12	2x #12	2x #12
Stranded (AWG)	#14 - #4	#14 - #4	#14 - #4	#14 - #1	#14 - #1
	2x (#14 - #12)	2x (#14 - #12)	2x (#14 - #12)	2x (#10 - #6)	2x (#10 - #6)
Torque	26.5 lb-in/3 Nm	26.5 lb-in/3 Nm	26.5 lb-in/3 Nm	31.1 lb-in/3.5 Nm	31.1 lb-in/3.5 Nm
Auxiliary Contacts					
Electrical characteristics	A300	A300	A300	A300	A300

FSLBS Dimensions (Inch/mm)

Rating	AC	F	F1	G	J	M	N	T
16, 25, 40A	4.33 / 110	1.77 / 45	0.59 / 15	2.68 / 68	0.59 / 15	1.18 / 30	2.95 / 75	0.59 / 15
63, 80A	4.33 / 110	2.07 / 52.5	0.69 / 17.5	3.00 / 76	0.69 / 17.5	1.38 / 35	3.35 / 85	0.69 / 17.5

1. Additional Pole - maximum of two, one each side
2. Auxiliary Contact - maximum of four, two each side

- E. Minimum is 1.18"/30mm, maximum is 14.6"/372mm
 D. Minimum is 1.18"/30mm, maximum is 9.25"/235mm

16A to 40A Direct operation "Toggle"

63A and 80A Direct operation "Rotary"

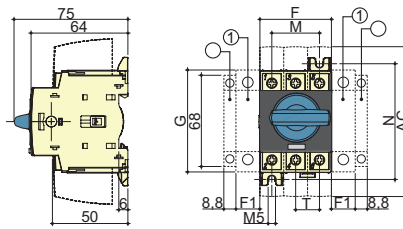
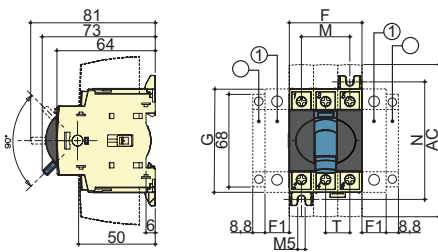

External front operation

External side operation

