



Terminal blocks Various technologies

-  rail type 1 and 2
-  reinforced rail type 2

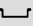
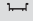

End stop		ép. 7,1 mm	BAH11	1SNA 164 659 R1000
End stop		th. 7,1 mm	BAH21	1SNA 167 489 R2200
Rail		35 x 7,5 x 1	PRH1P	1SNA 163 390 R0600
Rail		21,8 x 6,4	PRH2P	1SNA 163 370 R1100
Rail		21,8 x 8,2 x 1,5	PRH2R	1SNA 163 350 R1500

Other end stops, rails and accessories : see section on accessories.

Notes

41 H LT VV

Spacing 4,5 mm (.177")

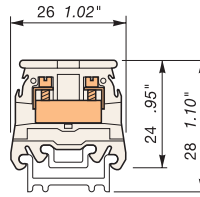

4,5 mm block with partition

41 H LSh VV

Spacing 4,5 mm (.177")

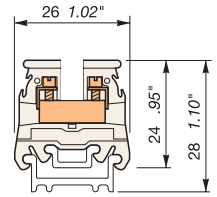

41 H LT VV with partition for jumper bar



Colour	Type	Part numbers
Colourless	41 H LT VV	1SNA 180 064 R2400

Colour	Type	Part numbers
Colourless	41 H LSh VV	1SNA 180 065 R2500

Characteristics

Wire size

		NFC DIN	UL	CSA
Screw clamp	Rigid	0-2,5 mm ²		
	Flexible	0-2,5 mm ²		

Characteristics

Wire size

		NFC DIN	UL	CSA
Screw clamp	Rigid	0-2,5 mm ²		
	Flexible	0-2,5 mm ²		

Voltage

V AC	380 VGr.C		
V DC	440 VGr.C		

Voltage

V AC	380 VGr.C		
V DC	440 VGr.C		

Current

Rated	20 A		
-------	------	--	--

Current

Rated	20 A		
-------	------	--	--

Wire size

Rated	1,5 mm ²		
Wire stripping length	Recomm. screwdriver	Recomm. torque	Protection
6 mm .24"	3 mm .118"	0,4-0,6 Nm 3.5-5.3 lb.in	

Wire size

Rated	1,5 mm ²		
Wire stripping length	Recomm. screwdriver	Recomm. torque	Protection
6 mm .24"	3 mm .118"	0,4-0,6 Nm 3.5-5.3 lb.in	

Accessories

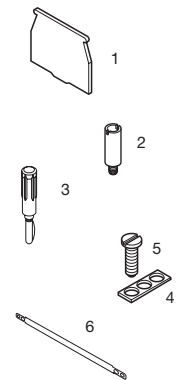

- 1 End section
- 2 Test socket
- 3 Test plug
- 4 Jumper bar
- 5 Screw for BJH
- 6 Shield connector

Type		Part numbers
FEH14	th. 1 mm	1SNA 183 676 R2500
AL2	DIA. 2 mm	1SNA 163 137 R1400
FC2		1SNA 007 865 R2600
BJH4 (1)	20 poles	1SNA 163 216 R2300
VSJ4		1SNA 163 359 R1200
CBH		1SNA 163 678 R1200

Type		Part numbers
FEH14	th. 1 mm	1SNA 183 676 R2500
AL2	DIA. 2 mm	1SNA 163 137 R1400
FC2		1SNA 007 865 R2600
BJH4 (1)	20 poles	1SNA 163 216 R2300
VSJ4		1SNA 163 359 R1200
CBH		1SNA 163 678 R1200

R See section on markers
Marking method

REH2
(1) Use of this accessory requires the user to cut out the partition of the terminal block.

